

FORGED STEEL GATE VALVES - ANSI CLASS 150~800

DESIGN DESCRIPTION:

- BOLTED BONNET
- O.S & Y

APPLICABLE STANDARDS:

- DESIGN PER API 602 / BS 5352
- SOCKET WELD AND THREADED END PER ANSI B16.11
- PIPE THREADS PER ANSI B1.20.1
- FLANGED END PER ANSI B16.5
- INSPECTON AND TEST PER API 598

SOCKET WELD ENDS
SCREWED ENDS
FLANGED ENDS

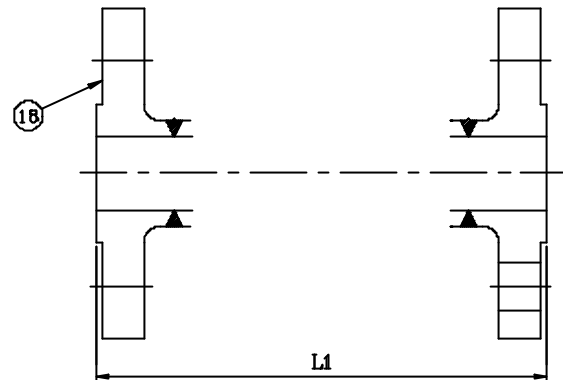
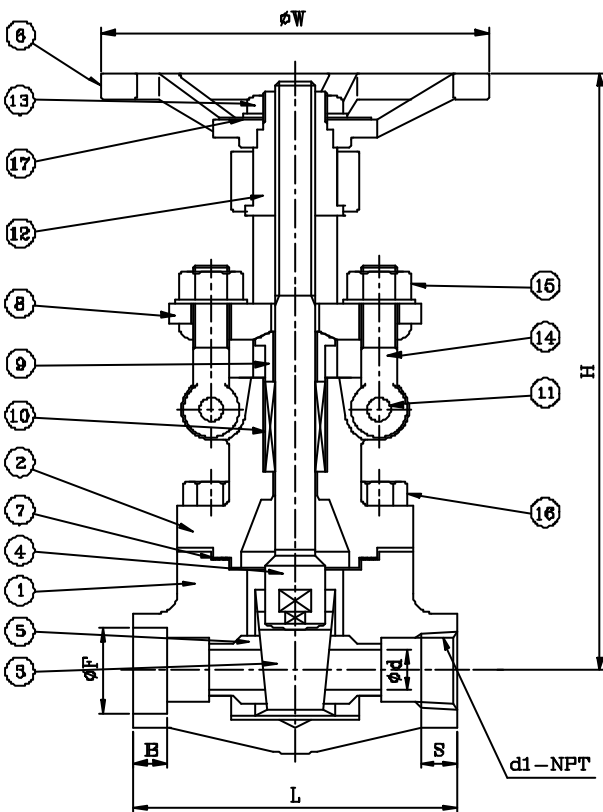

Flanged Ends

PARTS AND MATERIAL (ASTM)

| NO. | PARTS NAME | MATERIALS | |
|-----|---------------|------------------------------|------------------------------|
| | | F304 | F316 |
| 1 | Body | A182-F304 | A182-F316 |
| 2 | Bonnet | A182-F304 | A182-F316 |
| 3 | Disc | A351-CF8 | A351-CF8M |
| 4 | Stem | A276-304 | A276-316 |
| 5 | Seat | A276-304+H/F STL#6 | A276-316+H/F STL#6 |
| 6 | Hand Wheel | A47 | |
| 7 | Gasket | Grafoil + 304 Spiralwound | Grafoil + 316 Spiralwound |
| 8 | Gland Flange | A182-F304 | A182-F304 |
| 9 | Gland | A276-304 | A276-316 |
| 10 | Gland Packing | Graphite | |
| 11 | Eye Bolt Pin | A276-304 | |
| 12 | Stem Nut | A276-410 | |
| 13 | Wheel Nut | A108-1025 | |
| 14 | Eye Bolt | A193-B8 | |
| 15 | Eye Bolt Nut | A194-8 | A194-8 |
| 16 | Bonnet Bolt | A193-B8 | A193-B8 |
| 17 | Name Plate | A666-304 | |
| 18 | Flange | A182-F304 | A182-F316 |

TEST PRESSURE TO API 598

PSIG

| CLASS | SHELL TEST (water) | SEAT TEST (water) | SEAT TEST (air) |
|-------|---------------------------------|---------------------------------|-----------------------------|
| 150 | 450 (32 kg/cm ²) | 314 (22 kg/cm ²) | 80 (6 kg/cm ²) |
| 300 | 1125 (79 kg/cm ²) | 814 (57 kg/cm ²) | 80 (6 kg/cm ²) |
| 600 | 2225 (156 kg/cm ²) | 1628 (114 kg/cm ²) | 80 (6 kg/cm ²) |
| 800 | 3000 (210 kg/cm ²) | 2200 (154 kg/cm ²) | 80 (6 kg/cm ²) |

OTHER MATERIALS ARE AVAILABLE UPON REQUEST.

DIMENSION TABLE:

| DN | NPS | Ø d | L | L1 | | | H _(OPEN) | Ø W | SOCKET WELD | | SCREWED | | WT.(Kg) SW / NPT |
|----|-------|-----|-----|------|------|------|---------------------|-----|-------------|----|------------|------|---------------------|
| | | | | 150# | 300# | 600# | | | ØF | B | d1 | S | |
| 15 | 1/2 | 13 | 79 | 108 | 140 | 165 | 155 | 100 | 22 | 10 | 1/2" NPT | 13.5 | 1.9 |
| 20 | 3/4 | 13 | 92 | 118 | 152 | 191 | 155 | 100 | 27 | 13 | 3/4" NPT | 14.0 | 2.2 |
| 25 | 1 | 19 | 111 | 127 | 165 | 216 | 193 | 125 | 34 | 13 | 1" NPT | 17.5 | 4.1 |
| 40 | 1 1/2 | 29 | 120 | 165 | 190 | 241 | 248 | 160 | 49 | 13 | 1 1/2" NPT | 18.5 | 7.2 |
| 50 | 2 | 37 | 140 | 178 | 216 | 292 | 286 | 180 | 61 | 16 | 2" NPT | 19.0 | 10.8 |