

FORGED STEEL GATE VALVES - ANSI CLASS 150~800

DESIGN DESCRIPTION:

- BOLTED BONNET
- O.S & Y

APPLICABLE STANDARDS:

- DESIGN PER API 602 / BS 5352
- SOCKET WELD AND THREADED END PER ANSI B16.11
- PIPE THREADS PER ANSI B1.20.1
- FLANGED END PER ANSI B16.5
- INSPECTON AND TEST PER API 598

SOCKET WELD ENDS
SCREWED ENDS
FLANGED ENDS

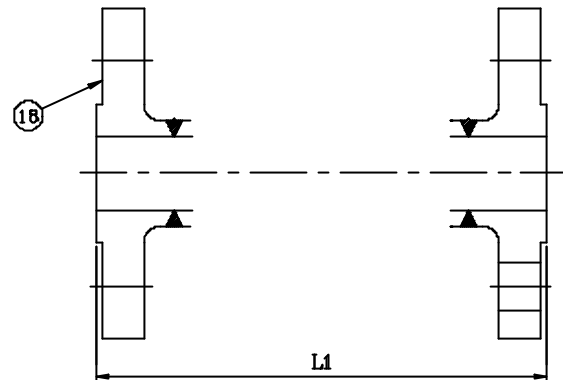
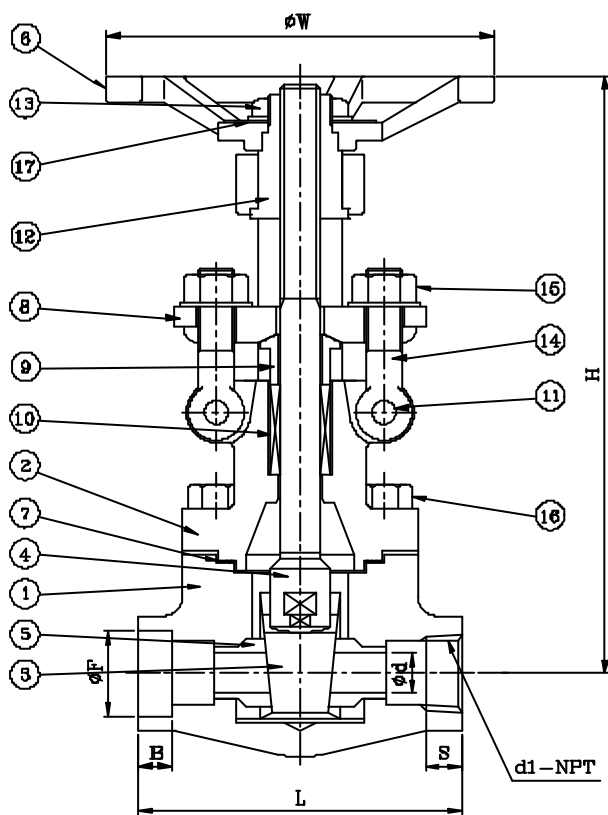

Flanged Ends

PARTS AND MATERIAL (ASTM)

NO.	PARTS NAME	MATERIALS
1	Body	A105
2	Bonnet	A105
3	Disc	A217-CA15
4	Stem	A276-410
5	Seat	A276-410+H/F STL#6
6	Hand Wheel	A47
7	Gasket	Grafoil + 304 Spiralwound
8	Gland Flange	A105
9	Gland	A276-304
10	Gland Packing	Graphite
11	Eye Bolt Pin	A276-304
12	Stem Nut	A276-410
13	Wheel Nut	A108-1025
14	Eye Bolt	A193-B8
15	Eye Bolt Nut	A194-2H
16	Bonnet Bolt	A193-B7
17	Name Plate	A666-304
18	Flange	A105

TEST PRESSURE TO API 598

PSIG

CLASS	SHELL TEST (water)	SEAT TEST (water)	SEAT TEST (air)
150	450 (32 kg/cm ²)	314 (22 kg/cm ²)	80 (6 kg/cm ²)
300	1125 (79 kg/cm ²)	814 (57 kg/cm ²)	80 (6 kg/cm ²)
600	2225 (156 kg/cm ²)	1628 (114 kg/cm ²)	80 (6 kg/cm ²)
800	3000 (210 kg/cm ²)	2200 (154 kg/cm ²)	80 (6 kg/cm ²)

OTHER MATERIALS ARE AVAILABLE UPON REQUEST.

DIMENSION TABLE:

DN	NPS	Ø d	L	L1			H _(OPEN)	Ø W	SOCKET WELD		SCREWED		WT.(Kg) SW / NPT
				150#	300#	600#			ØF	B	d1	S	
15	1/2	13	79	108	140	165	155	100	22	10	1/2" NPT	13.5	1.9
20	3/4	13	92	118	152	191	155	100	27	13	3/4" NPT	14.0	2.2
25	1	19	111	127	165	216	193	125	34	13	1" NPT	17.5	4.1
40	1 1/2	29	120	165	190	241	248	160	49	13	1 1/2" NPT	18.5	7.2
50	2	37	140	178	216	292	286	180	61	16	2" NPT	19.0	10.8